

AI Dashcam Plus

Installation guide

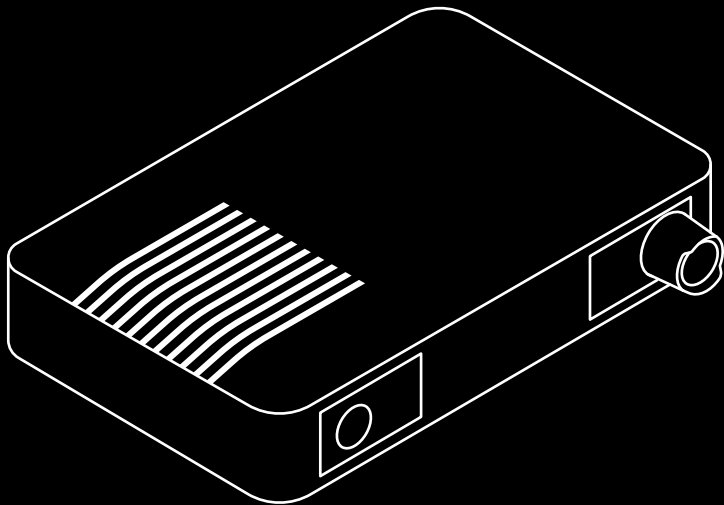

motive

Instructions in this manual apply to both Dual-facing and Road-facing AI Dashcam Plus.

Safety & Privacy

Motive's AI Dashcam Plus are a driver and fleet management aid only. They are not a substitute for safe, conscientious driving and cannot compensate for distracted, inattentive, or impaired driving. All warning and alert features provided by Motive products are for informational purposes only. No warning or alert feature provided by Motive products are intended to replace your responsibility to observe all road and driving conditions, abide by all traffic regulations, and use safe driving judgment at all times.

Video recordings made by the Motive AI Dashcam Plus are for personal or internal use only.

In some jurisdictions it could be considered an invasion of privacy rights to take or publicly display photographs or videos of people or their vehicles using this product or to publish or reproduce such photographs or videos. Further, some jurisdictions may have laws governing the collection, use, storage, and destruction of a person's biometric information, including face geometry and voiceprint. You are responsible for knowing and complying with applicable laws and rights to privacy in your jurisdiction, including obtaining proper consents and authorizations.

What's in the box

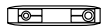

DC63(road facing)
or
DC64 (dual facing)



Cable clips



Vehicle
Adapter



Cable ties



Pin-hole
reset key



L-Key



Alcohol wipes

Note: Cables are shipped separately.

You should've also received the appropriate cable to match your vehicle. For cable-specific guidance, visit: gomotive.com/en-gb/ai-dash-cam-plus-install

Safety precautions

Before starting the installation, ensure the following:

- ⚠ The parking brake is engaged
- ⚠ The engine is off
- ⚠ The main power switch (if available) is turned off

Before you begin

Creating a vehicle profile and assigning a AI Dashcam Plus

1. Log in to the Fleet App and tap Devices.

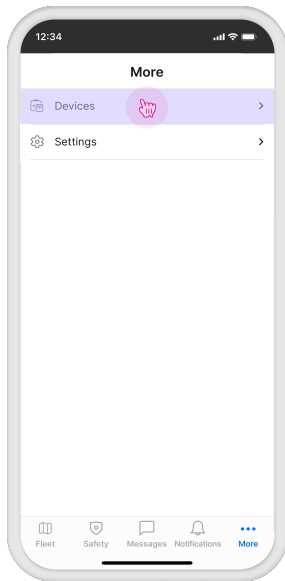

Before you begin

2. Tap Install AI Dashcam Plus

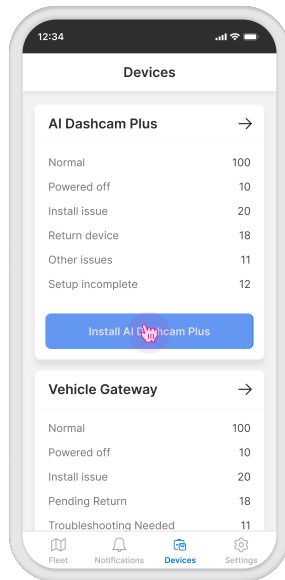

Before you begin

3. Scan the QR code on the side of the device or the barcode printed on the device box. You can also select from the list of available devices.

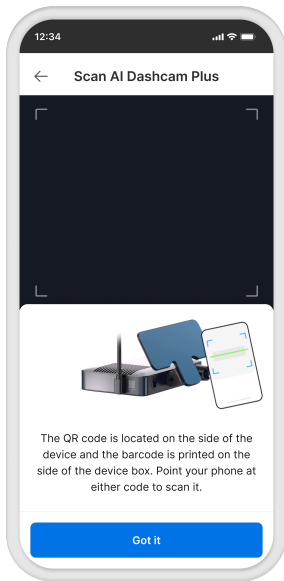

Before you begin

4. Scan the VIN of the vehicle in which you are installing AI Dashcam Plus. You can also enter the vehicle's VIN manually or select from the list of available vehicles.

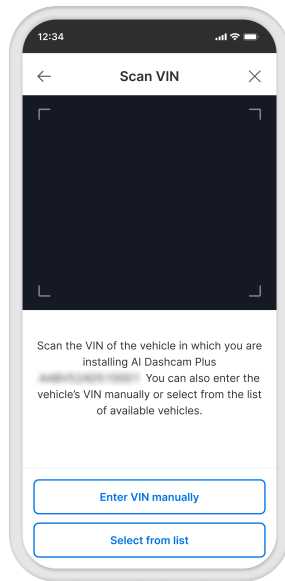

Before you begin

5. Once the vehicle details are confirmed, your vehicle will be added to your fleet, and your selected AI Dashcam Plus will be assigned to this vehicle

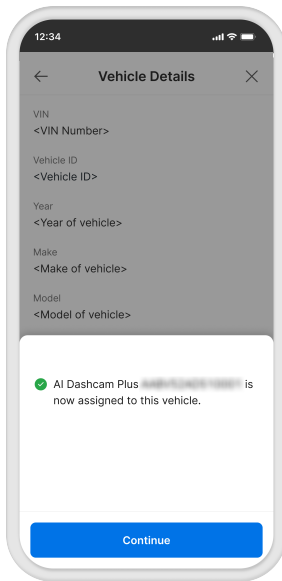

AI Dashcam Plus quick start guide

1. **Connect the AI Dashcam Plus**

Use the Motive provided cable to connect the AI Dashcam Plus to the diagnostic port of the vehicle.

2. **Test your mounting location**

We recommend mounting on the top center of the windshield or the left side of the rearview mirror. To ensure the best results, test its position by using the Motive Fleet App prior to mounting.

3. **Mount your AI Dashcam Plus**

Once you're satisfied with the location of your dashcam, you'll be ready to mount it to the windshield.

Refer to the step by step instructions on the next page.

1. Connect the AI Dashcam Plus

1.1 Locate the Diagnostic Port

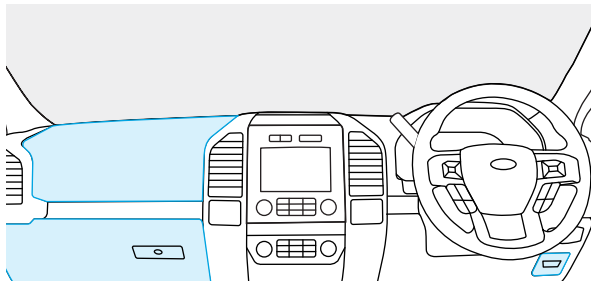

The diagnostic port location may vary depending on the vehicle. Refer to the images for the different locations for OBD-II port. Typical locations for the diagnostic port are:

- Driver's side footwell
- Under the dashboard near the steering column
- Near the fuse box

1. Connect the AI Dashcam Plus

1.2 Physical Install

Make sure you have everything you need to install your AI Dashcam Plus.

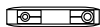

AI Dashcam Plus



Cable



Vehicle Adapter



L-Key



Alcohol wipes



Cable clips

Identify the diagnostic port and make sure you have the correct cable for your vehicle.

For more detailed cable-specific installation instructions, please refer to the cable-specific installation section under the gomotive.com/en-gb/ai-dash-cam-plus-install page.

1. Connect the AI Dashcam Plus

Identify the diagnostic port and make sure you have the correct cable for your vehicle.

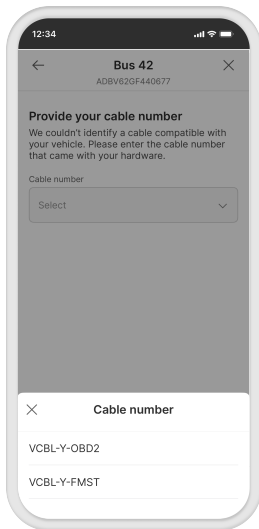

For more detailed cable-specific installation instructions, please refer to the cable-specific installation section under the [gomotive.com/en-gb/ai-dash-cam-plus-install](https://www.gomotive.com/en-gb/ai-dash-cam-plus-install) page. 9

1. Connect the AI Dashcam Plus

1.3 Plug the AI Dashcam Plus into the Vehicle Adapter

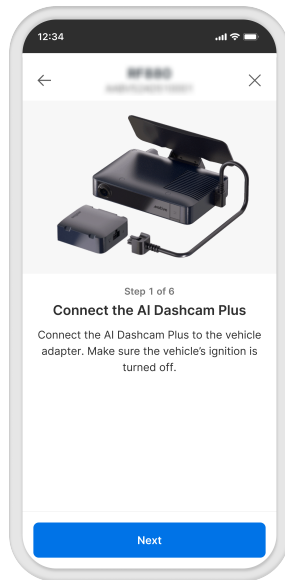

1. Connect the AI Dashcam Plus

1.4 Connect the Vehicle Adapter to the diagnostic port.

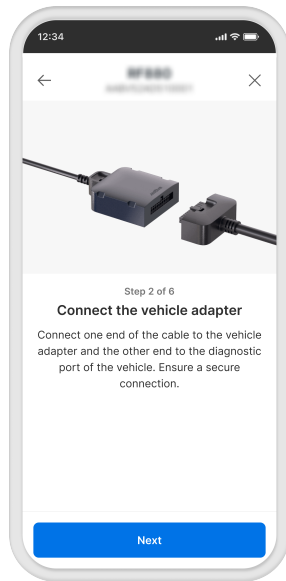

1. Connect the AI Dashcam Plus

1.5 Power on the vehicle and turn the engine ON

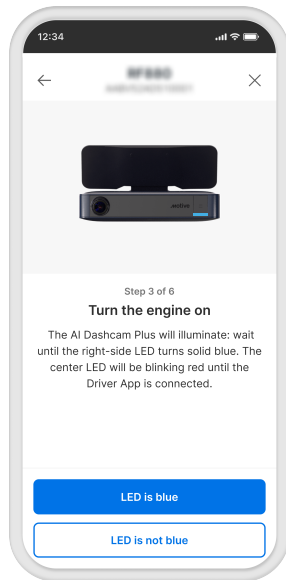

1. Connect the AI Dashcam Plus

1.6 Select a mounting location

Important Note: We recommend following the mounting location recommendations as outlined in this [article](#). The recommendations in this document are not to be considered legal advice. Fleets should consult their internal compliance and legal teams for advice on their legal rights and obligations related to their use of Motive products.

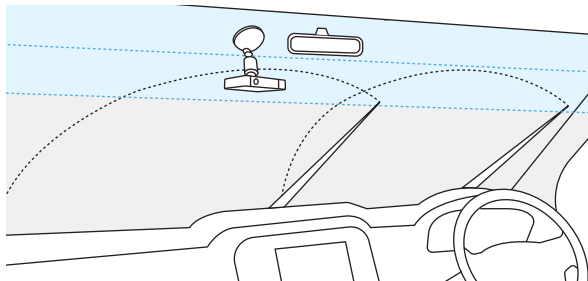

2. Test the mounting location

2.1 Hold the dashcam against the selected location with the cable running from the top. Don't remove the adhesive sticker on the mount at this stage.

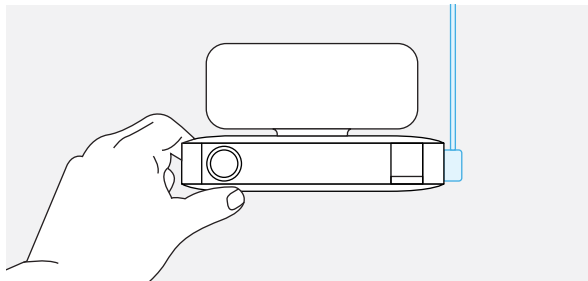

2. Test the mounting location

2.2 Adjust the camera

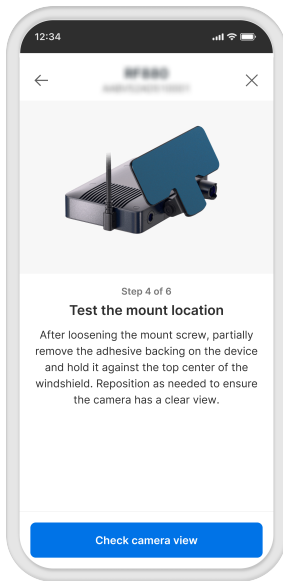

2. Test the mounting location

2.3 Make necessary adjustments to the AI Dashcam Plus for clearer images if required. Tap **Refresh All** to display the updated images

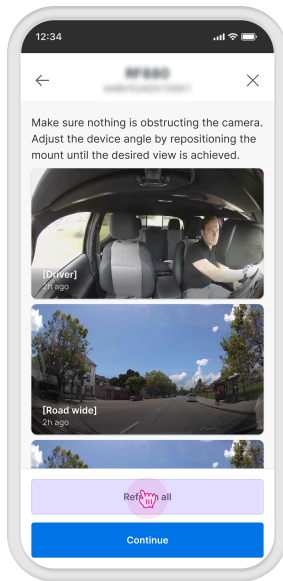

3. Mount your AI Dashcam Plus

3.1 Prepare for mounting

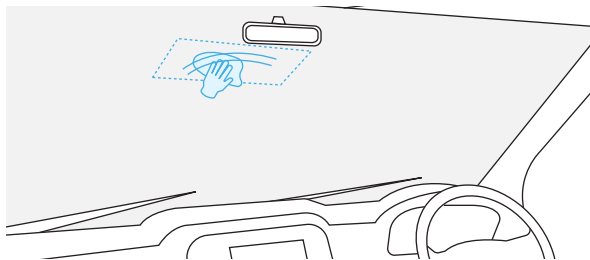

Clean the mounting location with the provided wipes.

Note: Dry the windshield after cleaning

3.2 Peel off the adhesive sticker from the mount

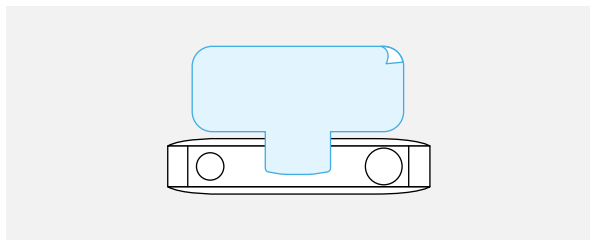

3. Mount your AI Dashcam Plus

3.3 Orient the dashcam so that the side with two lens is pointing towards the road. Gently apply pressure from the center outward until the dashcam is firmly attached to the windscreen, and no air bubbles are present.

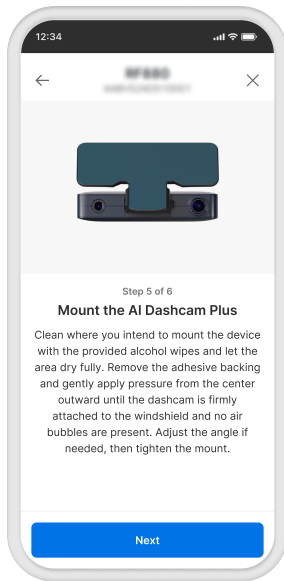

3. Mount your AI Dashcam Plus

3.4 Route the cable

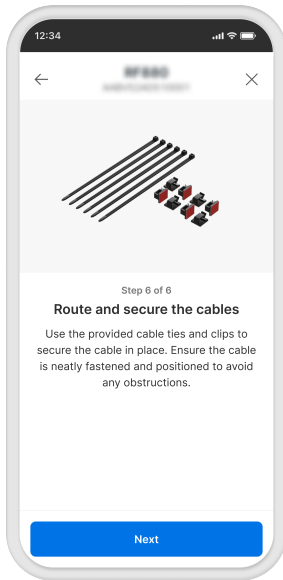

3. Installation Completed

3.5 Installation is complete!

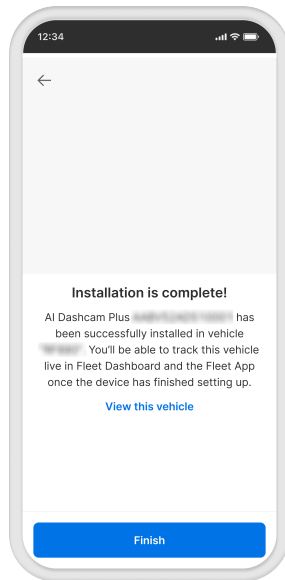





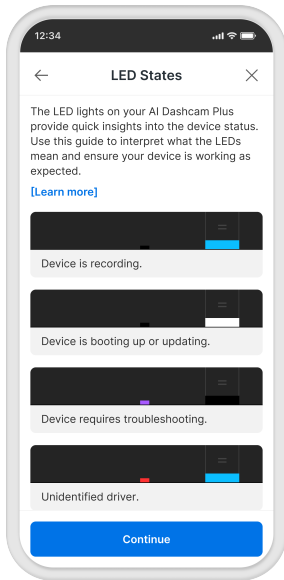

Understanding LED behavior

For complete list of LED indicators, refer to the [gomotive.com/en-gb/ai-dash-cam-plus-install](https://www.gomotive.com/en-gb/ai-dash-cam-plus-install)

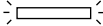

Understanding LED behavior

Connectivity LED	Alert LED	
None		Solid Blue Indicates the camera is ON and recording.
None		Blinking Red Indicates coachable events such as speeding, close following, etc
None		Blinking White Indicates the camera is starting or updating firmware
None		Solid Green Indicates the camera is in Privacy mode
	None	Blinking Red Indicates the driver app is not connected
	None	Purple Indicates the camera is overheating or requires troubleshooting

Notes

1. This device contains license-exempt transmitters/receivers that comply with Part 15 of the FCC Rules and with Innovation, Science and Economic Development Canada's License-exempt RSS(s).

Operation is subject to the following two conditions:

- a. This device may not cause harmful interference, and
- b. This device must accept any interference received, including interference that may cause undesired operation.

CAN ICES/NMB

2. Changes or modification warning

Any Changes or modifications not expressly approved by Motive Technologies, Inc. could void the user's authority to operate the equipment.

Notes

3. Information to the user

This equipment complies with FCC RF radiation exposure limits set forth for an uncontrolled environment and RSS 102 RF exposure compliance requirements. This equipment should be installed and operated with a minimum distance of 20 centimeters between the radiator and your body. This transmitter must not be co-located or operating in conjunction with any other antenna or transmitter.

This equipment has been tested and found to comply with the limits for a Class B digital device, pursuant to part 15 of the FCC Rules. These limits are designed to provide reasonable protection against harmful interference in a residential installation. This equipment generates, uses, and can radiate radio frequency energy and, if not installed and used in accordance with the instructions, may cause harmful interference to radio communications. However, there is no guarantee that interference will not occur in a particular installation. If this equipment does cause harmful interference to radio

Notes

Electrical Input
12-24V, 0.5A, 12W

Temperature rating
-20°C to 60°C

Designed in USA,
Assembled in Malaysia

frequency energy and, if not installed and used in accordance with the instructions, may cause harmful interference to radio communications. However, there is no guarantee that interference will not occur in a particular installation. If this equipment does cause harmful interference to radio or television reception, which can be determined by disconnecting, then reconnecting the equipment, the user is encouraged to try to correct the interference by one or more of the following measures:

- a. Reorient or relocate the receiving antenna.
- b. Increase the separation between the equipment and receiver.
- c. Connect the equipment into an outlet on a circuit different from that to which the receiver is connected.
- d. Consult the dealer or an experienced radio/TV technician for help.

Caution

- a. Battery replacement is not allowed.
- b. Disposal of a battery into fire or a hot oven, or mechanically crushing or cutting of a battery, that can result in an explosion;
- c. Leaving a battery in an extremely high temperature surrounding environment that can result in an explosion or the leakage of flammable liquid or gas; and
- d. A battery subjected to extremely low air pressure that may result in an explosion or the leakage of flammable liquid or gas
- e. High or low extreme temperatures that a battery can be subjected to during use, storage or transportation; and
- f. Low air pressure at high altitude.

Caution

Motive only supports and takes responsibility for batteries conforming with the AI Dashcam Plus. Batteries not designed for Motive AI Dashcam Plus are not supported and may pose a risk to your device and to your health and safety. Usage of batteries which do not comply with regional, national and international regulatory standards is strongly discouraged.

Warranty

Motive Technologies, Inc. (“Motive”) provides the Hardware Terms and Warranty, see more details, please refer to:

gomotive.com/legal/hardware-terms



EU Package Declaration of Conformity

Hereby we,

Manufacturer: Motive Technologies, Inc.
55 Hawthorne St., Suite #400, San Francisco, CA 94105, USA

EU authorised representative: Motive Technologies Netherlands B.V.
De Boelelaan 30, 1083 HJ Amsterdam, The Netherlands

declare under our sole responsibility, that:

Product name: Packaging (AI Dashcam Plus, Cable, Accessory Hub)

Model number: Installation guide	710110000028	EPE cotton bag	700710000049, 700710000050
PE accessories bag	700710000051	Gift box	700110000054, 700110000053
Insert card	700510000143	Carton	700310000104

The object of the declaration described above is in conformity with Regulation (EU) 2025/40 of the European Parliament and of the Council of 19 December 2024 on packaging and packaging waste, amending Regulation (EU) 2019/1020 and Directive (EU) 2019/904, and repealing Directive 94/62/EC

with reference to the following harmonized standardizations applied:

PPW Regulation (Regulation (EU) 2025/40, and its amendments)

EN 62321-1	EN 62321-2	EN 62321-3-1
EN 62321-3-2	EN 62321-3-3	EN 62321-3-4
EN 62321-4	EN 62321-5	EN 62321-6
EN 62321-7-2	EN 62321-7-1	EN 62321-8

The conformity assessment procedure under the EU Package Regulation (EU) 2025/40 has been carried out under the internal production control procedure in line with module A of Annex II to Decision No 768/2008/EC

Signed for and on behalf of: Motive Technologies, Inc.

Date and place:

23 Apr., 2025 / San Francisco, CA, USA

Functional:

SVP, Hardware Devices

Name:

Amish Babu

Signature:



EU CE RED Declaration of Conformity

Hereby we,

Manufacturer: Motive Technologies, Inc.
55 Hawthorne St., Suite #400, San Francisco, CA 94105, USA

EU authorised representative: Motive Technologies Netherlands B.V.
De Boelelaan 30, 1083 HJ Amsterdam, The Netherlands

declare under our sole responsibility, that the radio equipment:

Product name: AI Dashcam plus
Model number: DC64-WW.01, DC63-WW.01
Hardware version: 1.0
Software version: 0.6.0
Accessories: Adapter (VIA-WW), OBD-II Y-cable (6001, VCBL)

is in conformity with the relevant Union harmonization legislation:

Radio Equipment Directive: 2014/53/EU (RED), Hazardous Substance Directive: 2011/65/EU (RoHS)

with reference to the following harmonized standardizations applied:

Health and Safety (Article 3.1 (a) of the Radio Equipment Directive)

EN IEC 62368-1:2020+A1:2020	EN IEC62368-1:2014+AC:2015	IEC 62133-2:2017
EN 62311:2008	EN IEC 62311:2020	EN 50665:2017

Electromagnetic compatibility (Article 3.1 (b) of the Radio Equipment Directive)

ETSI EN 301 489-1 V2.2.3	ETSI EN 301 489-3 V2.3.2	ETSI EN 301 489-17 V3.2.4
ETSI EN 301 489-19 V2.2.1	ETSI EN 301 489-52 V1.2.1	EN 55032:2015+A11:2020
EN 55035:2017+A11:2020	-	-

Radio Spectrum (Article 3.2 of the Radio Equipment Directive)

ETSI EN 300 328 V2.2.2	ETSI EN 300 440 V2.1.1	ETSI EN 301 511 V12.5.1
ETSI EN 301 908-1 V15.2.1	ETSI EN 303 413 V1.2.1	-

Radio Spectrum (Article 3.3 (d), (e) of the Radio Equipment Directive)

EN 18031-1	EN 18031-2 -	-
------------	--------------	---



EU CE RED Declaration of Conformity

RoHS Directive (Directive 2011/65/EU, and its amendments)

EN IEC 63000:2018

The conformity assessment procedure under the EU Radio Equipment Directive (RED), 2014/53/EU has been carried out in accordance with Annex II, Module A, ensuring compliance with the essential requirements specified in Articles 3.1(a), 3.1(b), 3.2, and 3.3(d) of the Directive.

Signed for and on behalf of: Motive Technologies, Inc.

Date and place:

23 Apr., 2025 / San Francisco, CA, USA

Functional:

SVP, Hardware Devices

Name:

Amish Babu

Signature:

Troubleshooting

+44-80-0055-6684

support@gomotive.com

help.gomotive.com

Resources



Scan this code or visit the link below to access your online Dashcam Plus Guide: gomotive.com/en-gb/ai-dash-cam-plus-install

Included is the most up-to-date information about dashcam hardware, safety features, and fleet settings, as well as installation support in multiple languages.