

# Cable VCBL-Y-1226

AI Dashcam Plus installation guide for vehicles  
with RP1226 port

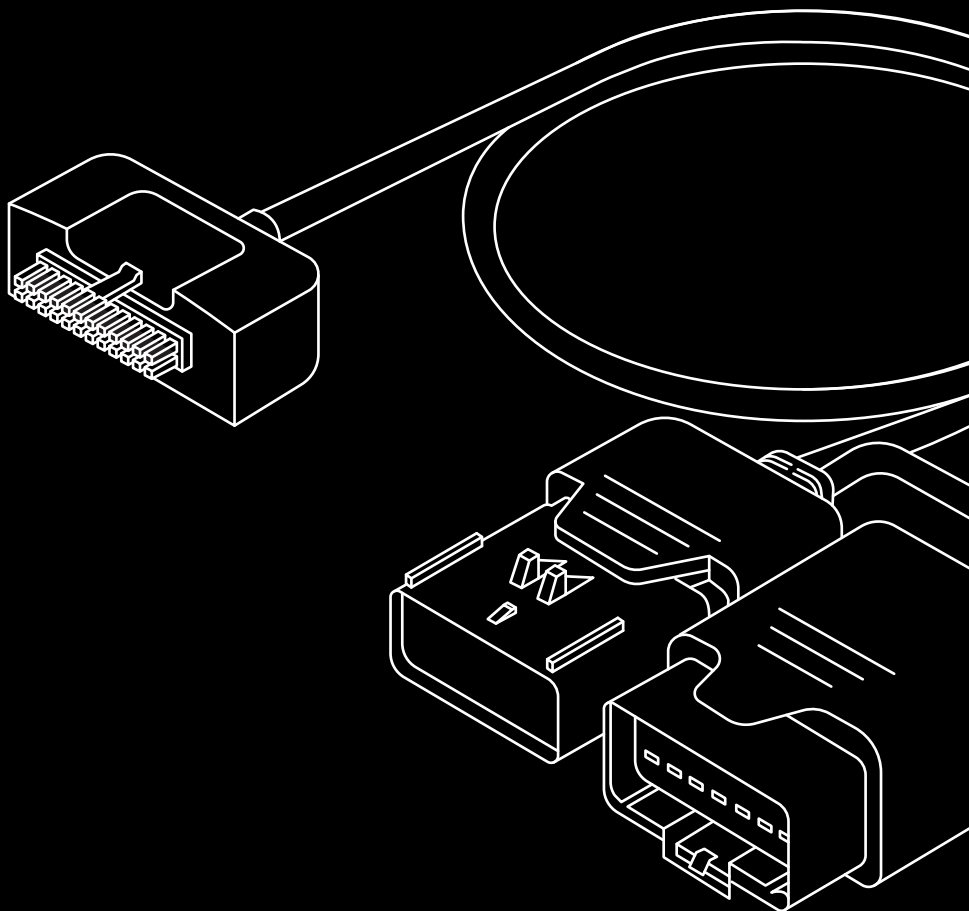

**motive**

In the box

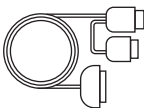

Cable VCBL-Y-1226

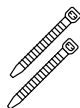

Cable ties

Tools Required

- **Screwdriver Set**
- **Plastic prybar**
- **Socket set**

Safety Precautions

Before starting the installation, ensure the following:

- The parking brake is engaged.
- The engine is off.
- The main power switch (if available) is turned off.

The **VCBL-Y-1226** cable includes three labeled ends:

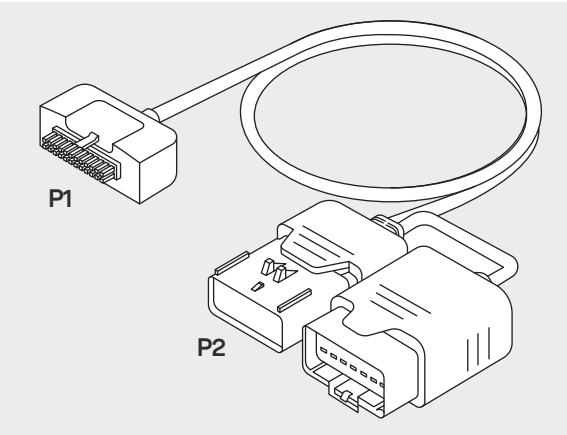

Cable End	Description
P1	Connects to the vehicle adapter
P2	Connects to the vehicle's RP1226 telematics port
P3	Optional: Connects to the dashboard receptacle to maintain the telematics port accessible for other uses. Required with Y-cable installations

**Important Note**  
Many newer heavy-duty vehicles with an RP-1226 connector also include a standard diagnostic port. However, it is recommended to avoid using the standard diagnostic port and instead connect through the RP-1226 connector. Using the diagnostic port in place of the RP-1226 connector may void the vehicle's warranty.

## 1. Locate the RP1226 port

### Kenworth and Peterbilt

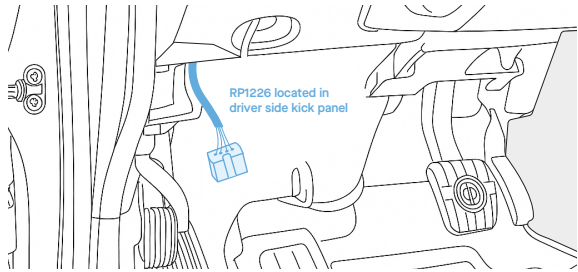

In Kenworth and Peterbilt trucks, the RP1226 connector is located on the driver's left side of the cab. To access it, remove the fuse box panel located below the 9-pin diagnostic port. In some cases, the panel beneath the fuse box may also need to be removed. The connector is typically tucked behind the fuse box.

### Freightliner Cascadia

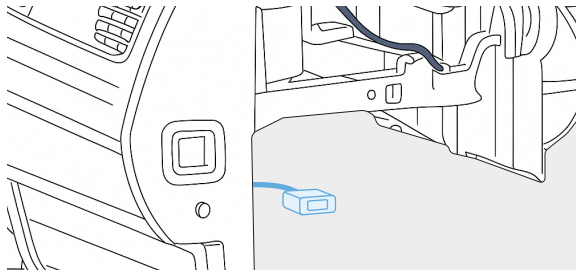

For 2018 model year and newer Freightliner Cascadia trucks, the RP1226 connector is located on the passenger side of the cab. To access the connector, remove the lower panel, as shown in the image below.

1. Locate the RP1226 port

**Freightliner M2, 108SD, 114SD**

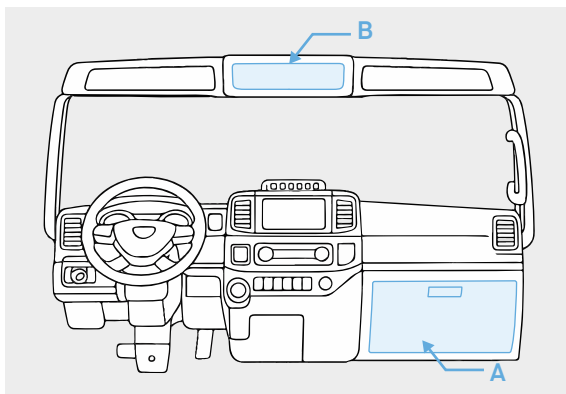

For the 2020 Freightliner M2, 108SD, and 114SD models, the RP1226 connector is typically located either in the passenger-side doghouse beneath the fuse box (Location A) or in the center of the overhead console (Location B), if equipped

**Western Star**

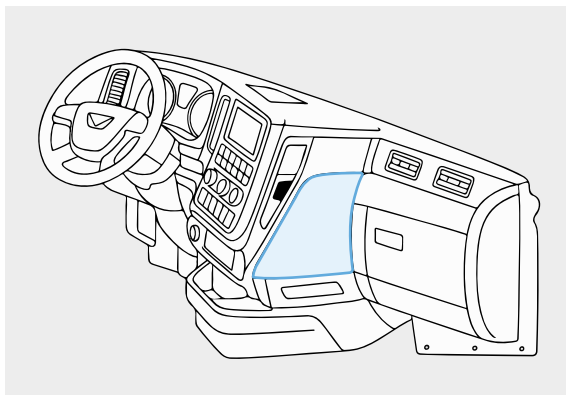

For Western Star models 47X and 49X, the RP1226 connector is located on the left side of the passenger-side dashboard, behind the center console.

1. Locate the RP1226 port

**Mack**

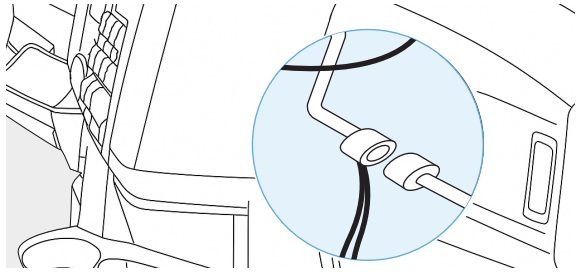

For Mack vehicles, the RP1226 connector is typically located in the passenger-side dashboard, either behind or beneath the fuse box. In some cases, it may also be found within the fuse box area.

**Volvo**

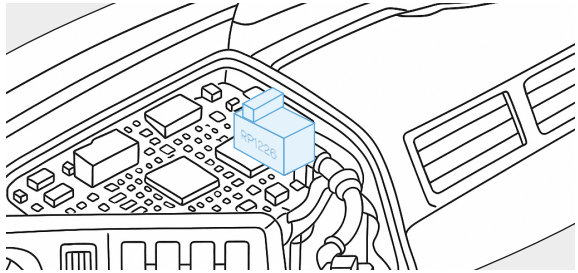

For Volvo trucks, the RP1226 connector is located at the top of the dashboard within the fuse box compartment.

2. Connect the AI Dashcam Plus

**WARNING!** California state law prohibits relocating the in-vehicle RP1226 connector during installation. To remain compliant, always follow the Direct Plug-In installation instructions when installing this cable.

**2.1 Plug the AI Dashcam Plus**

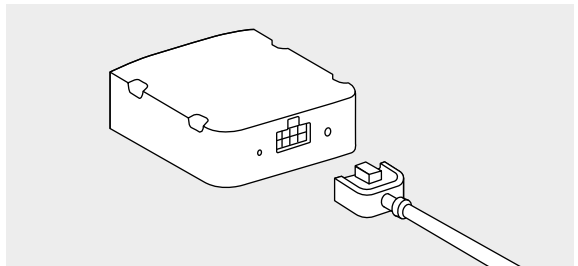

Plug the AI Dashcam Plus cable into the vehicle adapter

## 2. Connect the AI Dashcam Plus

### 2.2 Connect the vehicle adapter

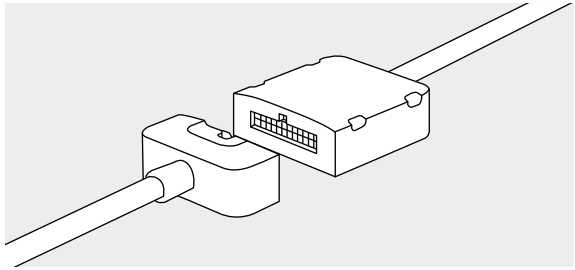

Plug the vehicle adapter into one end of the Y cable (P1).

### 2.3 Connect the RP1226 port

#### Option 1: Direct Cable Connection

Use this method if you're connecting the cable directly into the vehicle's RP1226 port or operating in the state of California

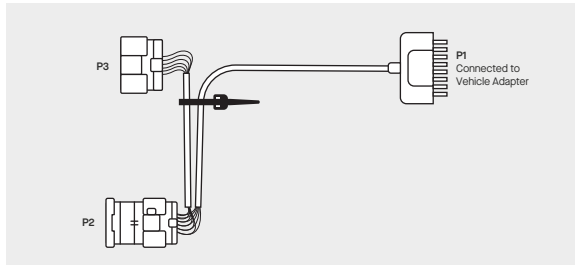

#### Steps:

1. Plug the male end of the Motive cable (P2) directly into the vehicle's RP1226 port.
2. Secure the connection and use a cable tie to fasten the shorter cable P3 (which has the spare connector) to the main cable. Place the zip tie near the spare connector for secure fastening
3. The P3 end is not used for this installation type

**Note:** The OEM telematics port will not be available while the cable is plugged in.

## 2. Connect the AI Dashcam Plus

### Option 2: Y-Cable Connection

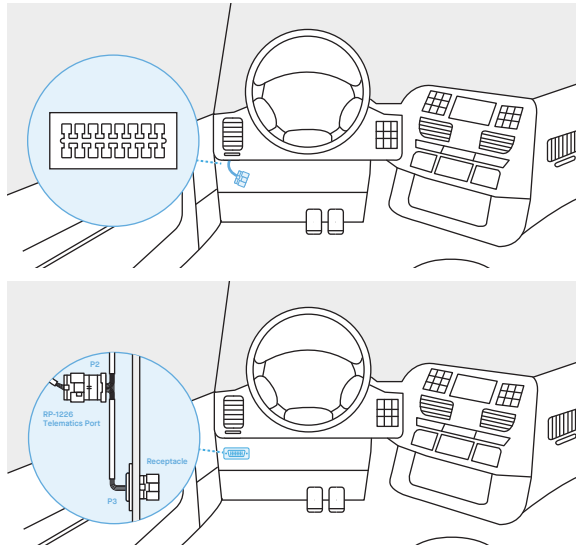

#### Steps:

1. Remove the OEM RP1226 port from its receptacle in the dashboard.
2. Plug the male end of the Motive cable (P2) into the removed RP1226 port.
3. Install and secure the female end of the Motive Cable (P3) into the original receptacle where the telematics port was located in the vehicle

### 2.4 Lock the connectors

Push the orange tab over to lock the RP-1226 connectors.

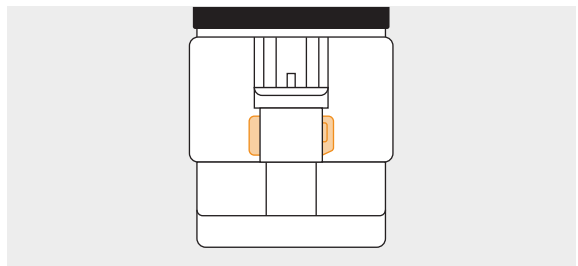

### 3. Test and Mount the AI Dashcam Plus

Refer to the AI Dashcam Plus Installation Guide available at [gomotive.com/aidashcamplus-install](https://gomotive.com/aidashcamplus-install) for instructions on testing and mounting the device to the vehicle's windshield or the left side of the rearview mirror.

Once mounted, the final installation should resemble the example shown here

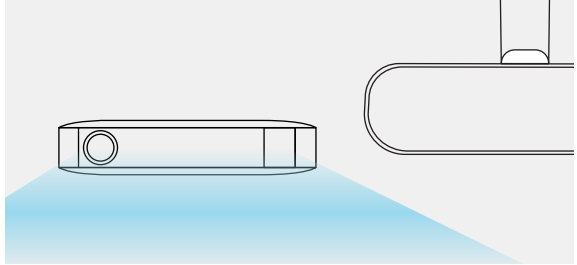

---

#### Power Connection

Start the vehicle's engine. Once the alert/right LED turns blue, your AI Dashcam Plus is powered on and connected!

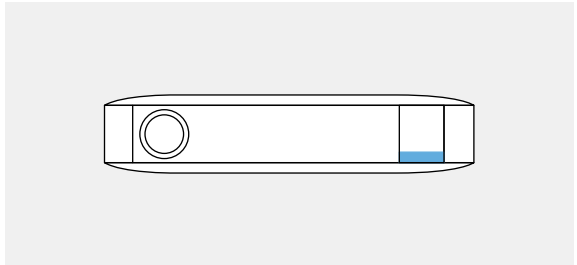



# Potential Unlocked

**motive**

[gomotive.com](http://gomotive.com)